



# Using ID.Delaware.gov to Connect to State VPN for Telework

## Initiating VPN using web browser:

1. Navigate to **id.delaware.gov** and login using your State Email and password

Next you would need to verify your identity using one of the MFA factors you have registered for.

2. If you registered for more than one factor (SMS, Voice Call, Okta Verify), you will see a little triangle to open the list and select the one you want to use:

3. For example, for text message, select SMS Authentication

4. Then Click on **Send Code** to get a code sent to your phone:
5. Once you get the code, enter it in the box and click **Verify Code** button to sign in.

6. After logging to your Dashboard, click Pulse Secure tile to open and launch VPN connection.

7. If you use VPN to connect to your work machine, now you would launch Microsoft Remote Desktop from your home computer.

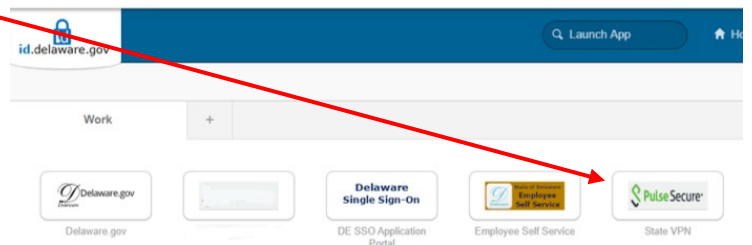
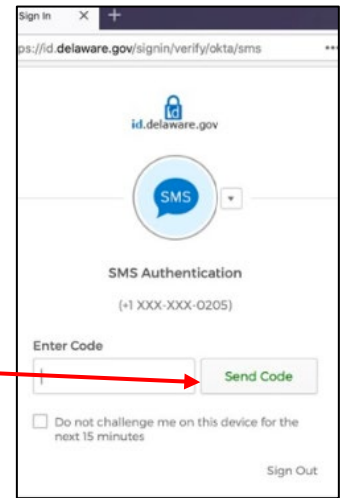
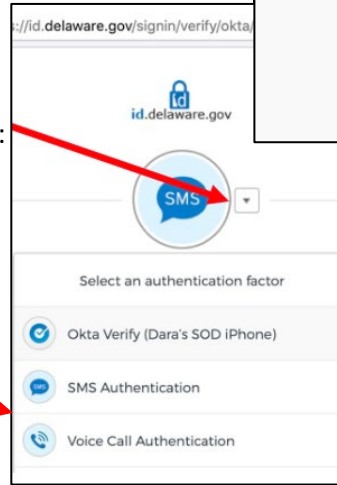
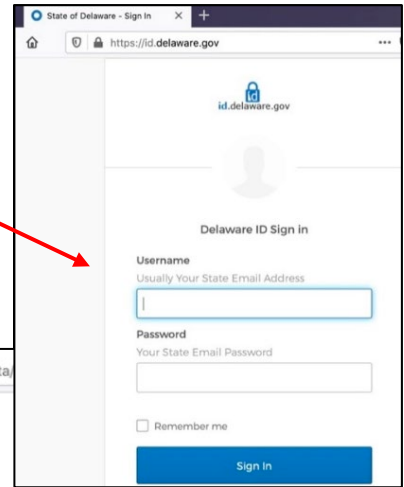

## Initiating VPN using local Pulse Client

1. Open Pulse Client and add a new connection and then connect.
2. It will require you to verify your identity using a MFA factor you already registered.
3. Once you successfully verify your identity the connection will be established.
4. Connect to your work machine using Microsoft Remote Desktop

